







Step by step assembly guide

7.51m x 3.66m

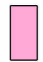
Please read before starting construction

### Installation Notes & Information

- Dimensions shown are a guide only. Due to the changes in temperature & relative humidity causing wood to expand or contract, we suggest checking all timber cutting dimensions during assembly.
- Please ensure all instructions are thoroughly reviewed prior to commencement of build.
- 2 persons recommended for assembling of building
- Always wear appropriate PPE & correct equipment when using any tools or working from height

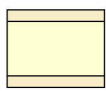
Timber Legend	
	2" x 1" Timber
	3" x 2" Timber
	4" x 2" Timber
	5" x 2" Timber
	6" x 2" Timber
	6" x 3" Timber
	SIP Spline

### Recommended Safety Equipment

- Safety glasses
- Gloves
- Knee pads
- Safety boots/shoes
- Hearing protection when using power tools

### Recommended Roof Installation Equipment

- 2" silicon hand roller
- Penny roller
- Stiff broom
- 9" paint roller frame & medium nap, solvent compatible roller covers
- Safety glasses & Eye cleaning solution
- Mastic gun
- Crayon
- Rubber Gloves
- Tin Snips
- Scissors
- Cotton rags

### Recommended Tools and additional materials required (not supplied):

- Impact driver & drill with driver bit set.
- Circular saw/ manual saw
- Rubber Mallet
- Claw Hammer
- Spirit level
- Cutting Knife
- Sweeping brush
- Nail gun
- Planer
- Tape Measure
- Staple Gun
- Staples for membrane/DPC
- Stainless steel brad nails (45mm minimum)
- External stain/oil for cladding
- Suitable timber bearers/ base support (4x2 timbers at 600mm centres)
- External beading silicone sealant

**1 Floor Timbers**  
1:35

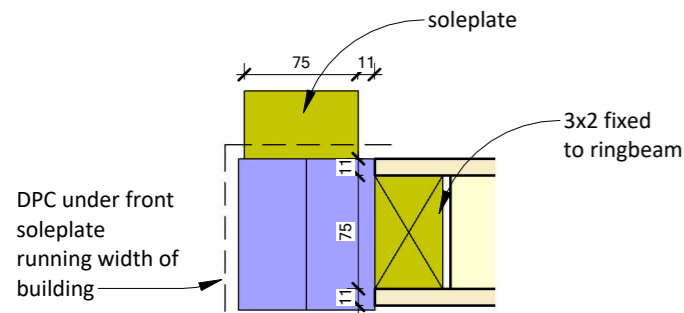
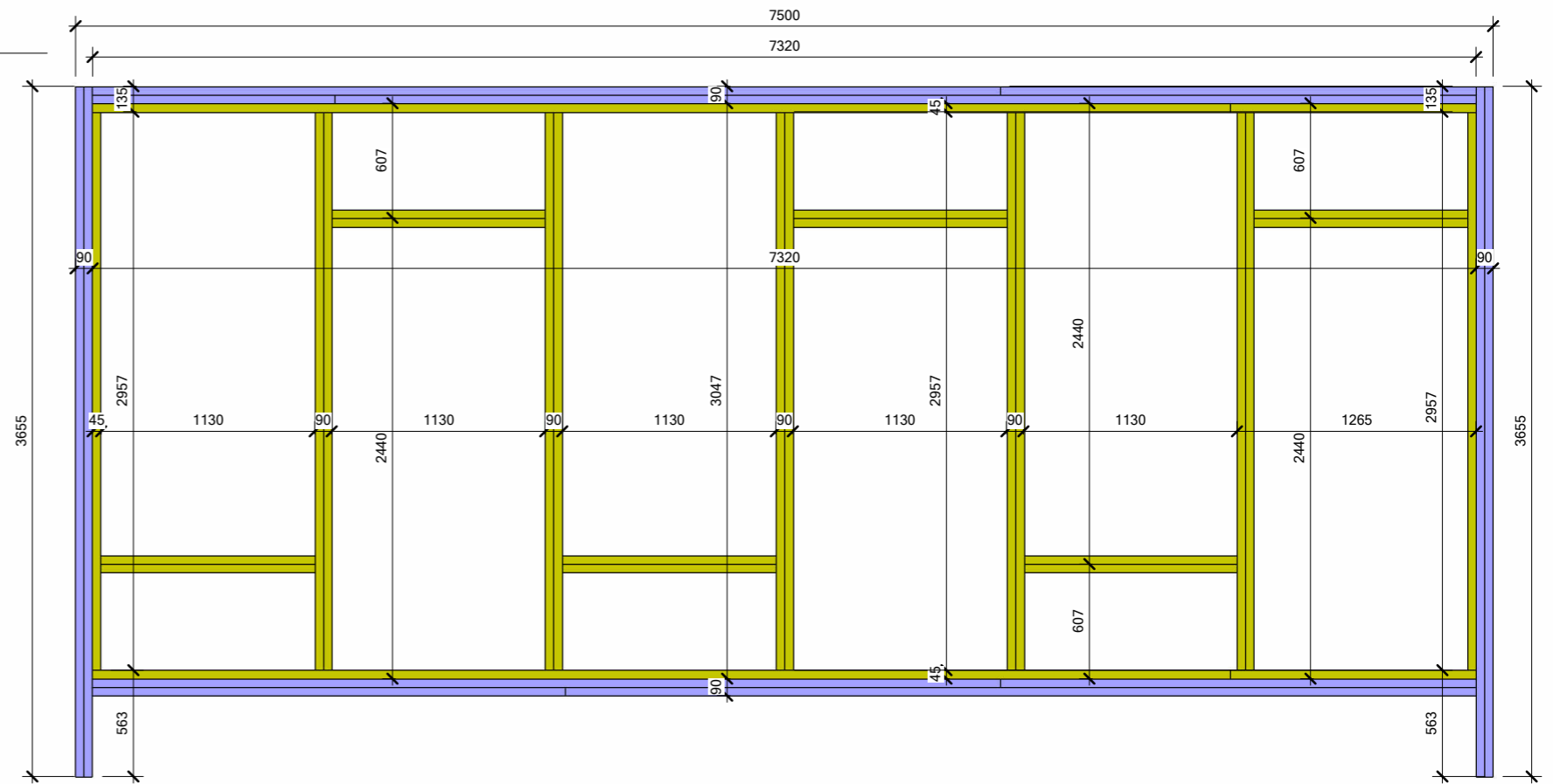

**3 Floor Sect**  
1:5

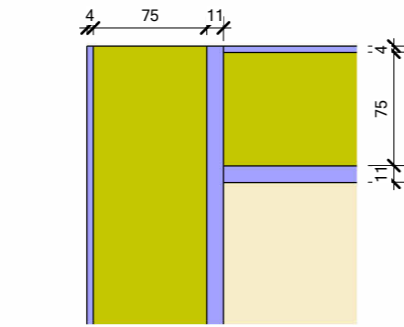

**4 Sole Plate Detail**  
1:5

- Glue floor beam using PU Adhesive generously across the 70mm face of timber. Screw through both timbers using 5x80mm screws every 400mm. Beam fitted into 50mm rebate of panel using 30x 5x50mm screws through face of OSB
- Glue 4x2" ring beam using PU Adhesive generously across the 100mm face of timber. Screw through both timbers using 5x80mm screws every 400mm
- 3x2" joining splines to be glued & screwed to 4x2" ring beam in positions shown in drawing. 3"x2" splines then fitted into panel rebates
- 3x2" soleplate to be screwed in position as shown every 400mm into ringbeam using 5x80mm screws. Allow 11mm to inside of ring beam to allow for OSB on SIP panel

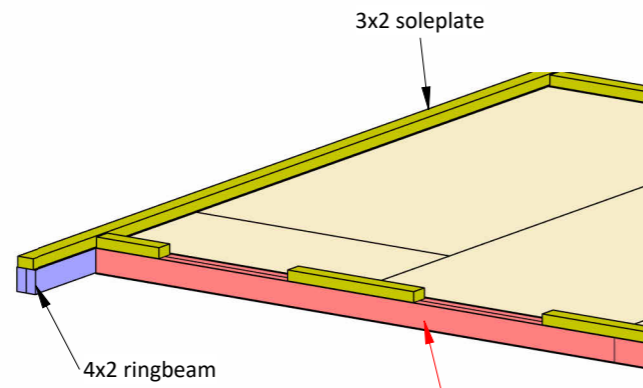

DPC to be installed under any doors & windows & under front soleplate running full width of building

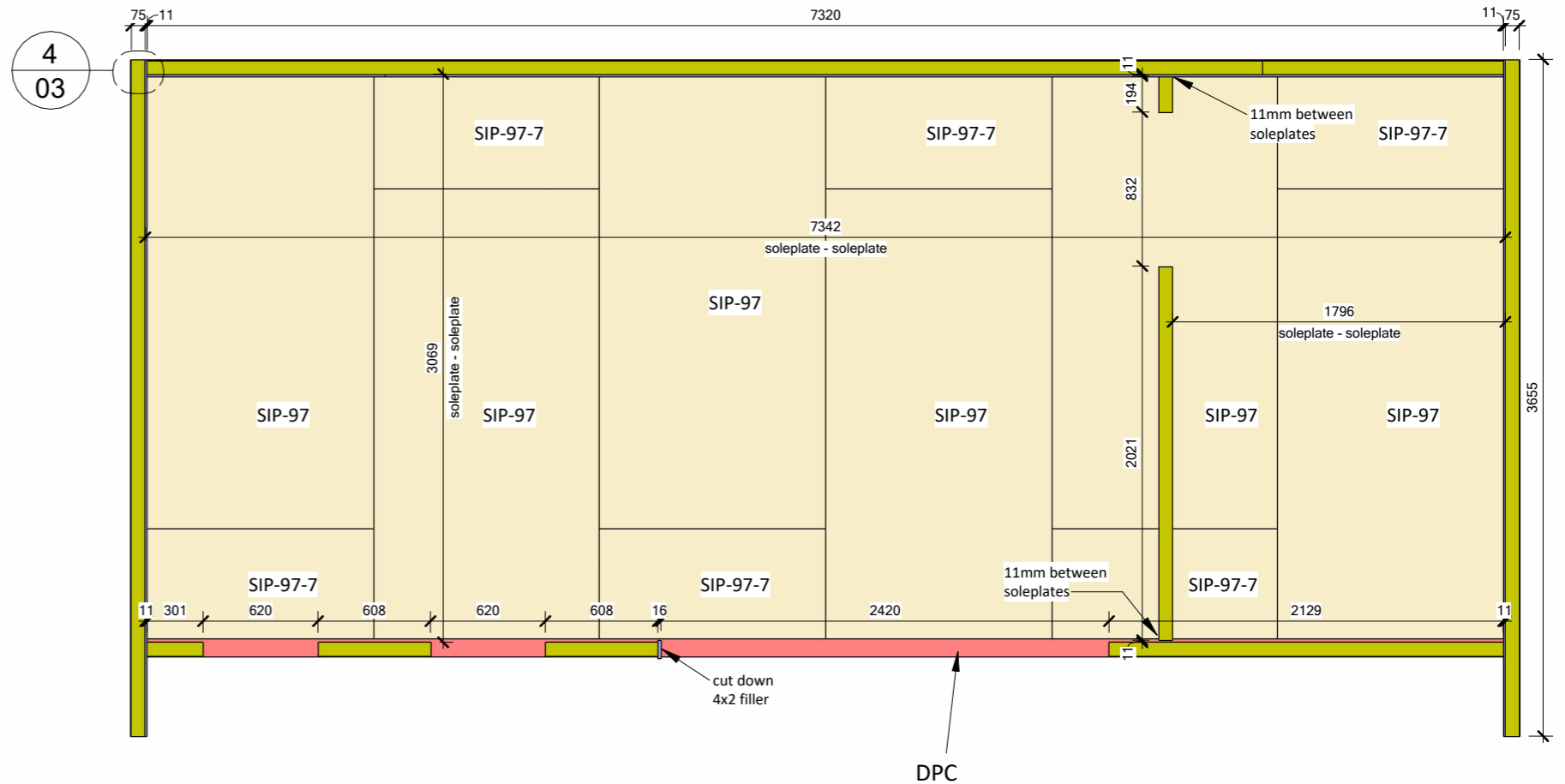

**2 Floor Panels & Sole Plate**  
1:35

**03. Floor Assembly**

- SIP panels to be positioned over sole plates, glued & screwed through face of OSB into vertical & horizontal joining splines using 5x50mm screws @400mm centres
- Double 3x2" timber to be used as jointing spline at wall joints; insulated spline to be used between SIP panels as shown
- Top plate to be glued & screwed into position using 5x80mm screws @ 400mm centres
- furring strips to be doubled up side by side & fixed down to top plate with 5x80mm screws @1200mm centres

- 9mm OSB strip to be glued & nailed to end of side walls to underside of furring strip for future connection of cladding
- Front & rear panel vertical timber splines to be fixed into timber in side walls using 6x150mm screws before installation of the SIP panels

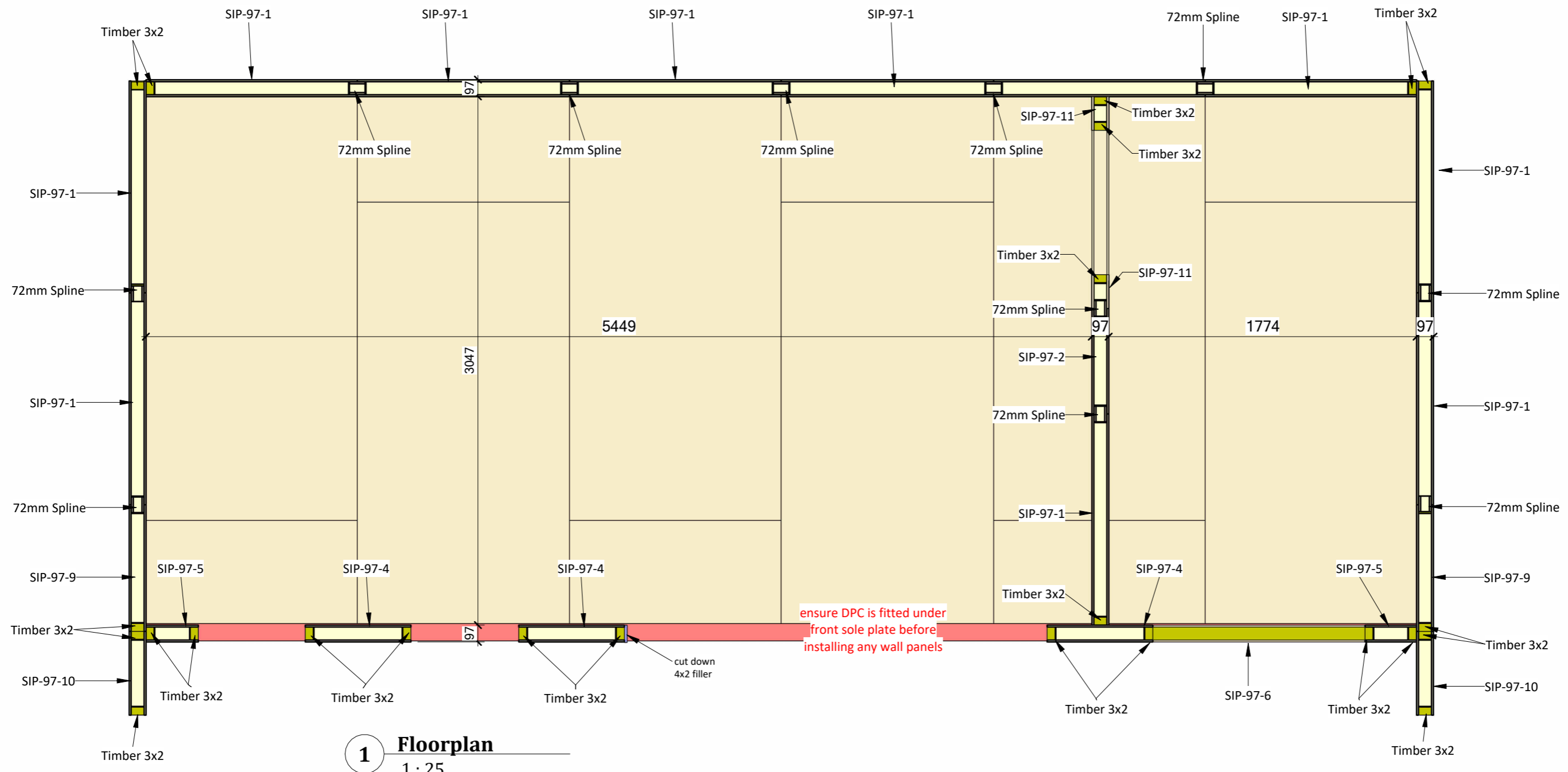

**1 Floorplan**  
1 : 25

**04. Wall Plan**

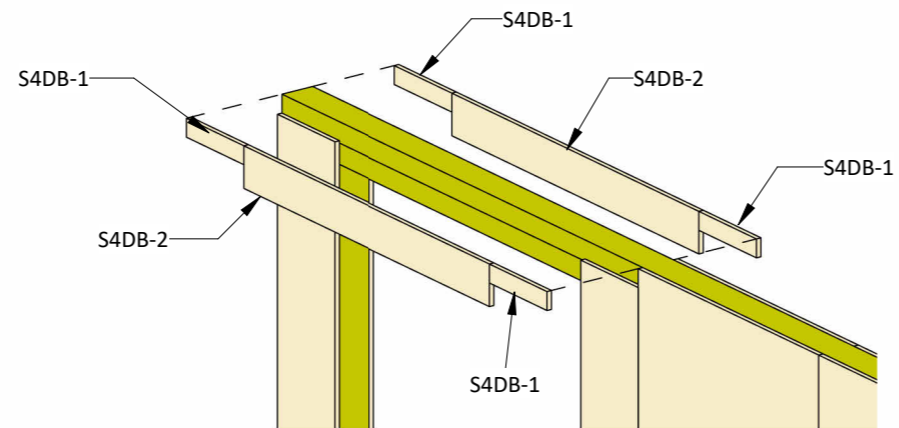

**6 Int wall door bar**

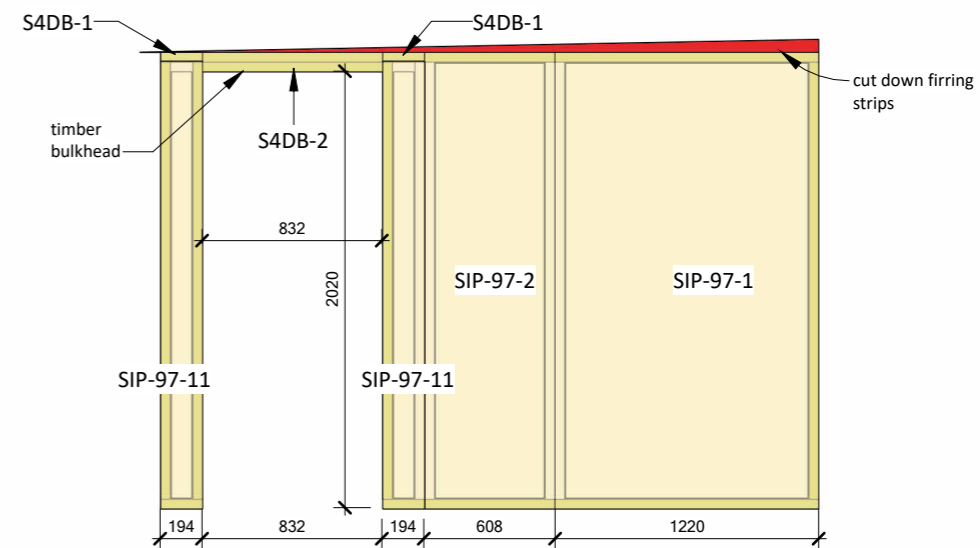

**5 Internal Wall**  
1 : 35

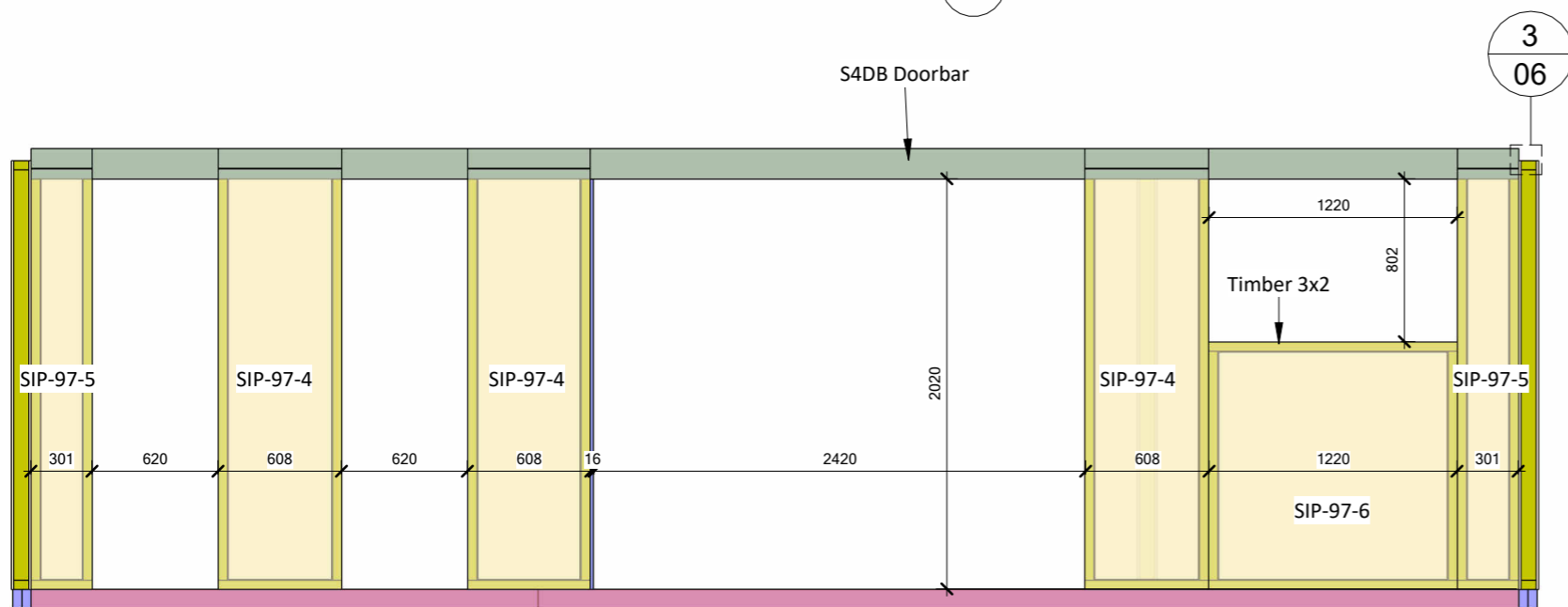

**1 Front Wall**  
1 : 35

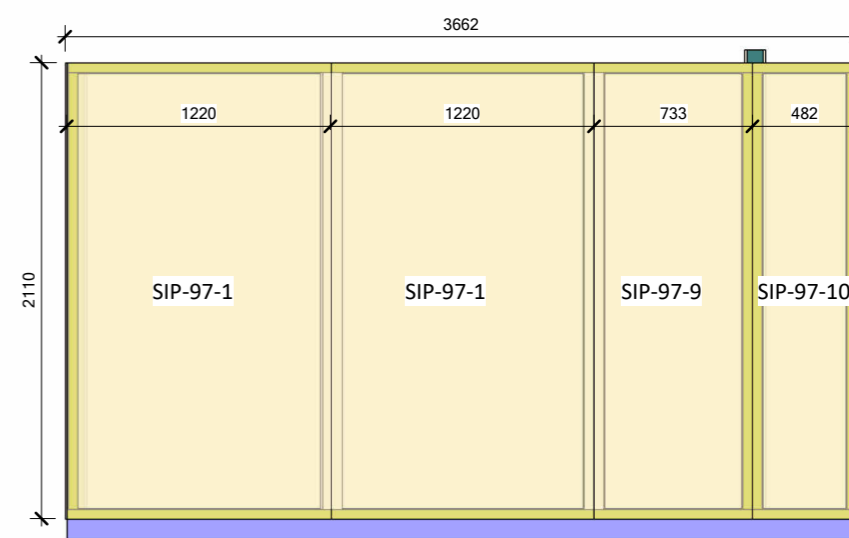

**3 Left Wall**  
1 : 35

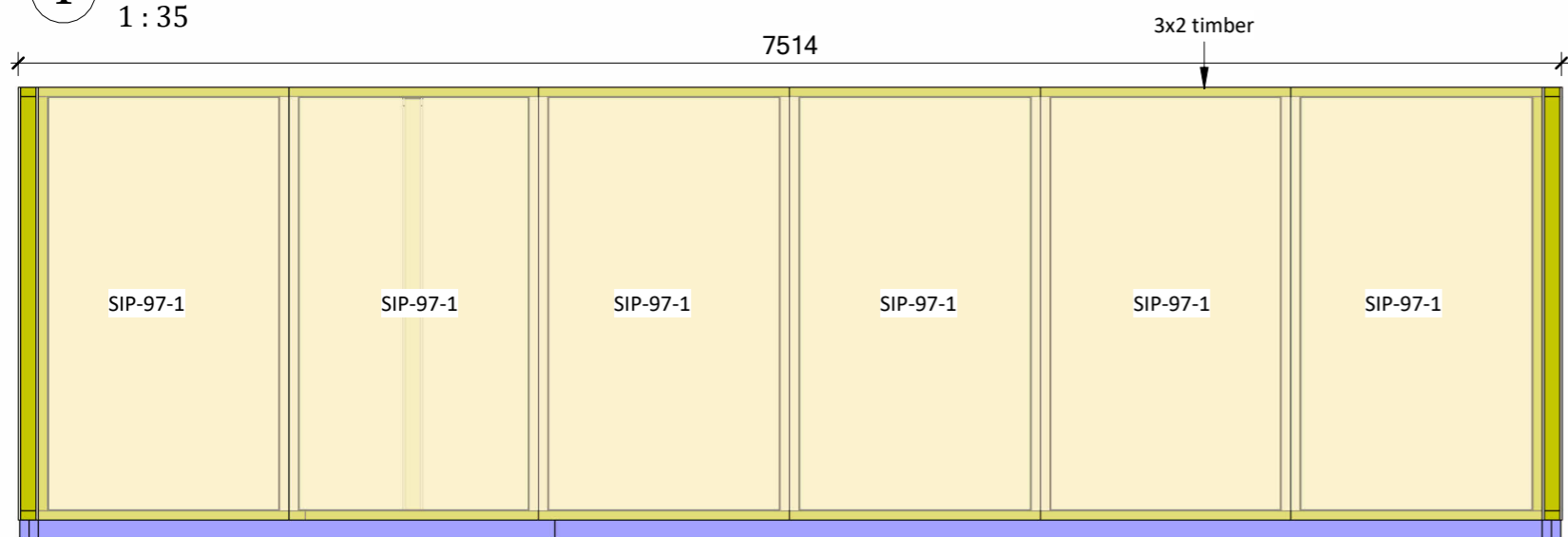

**4 Back Wall**  
1 : 35

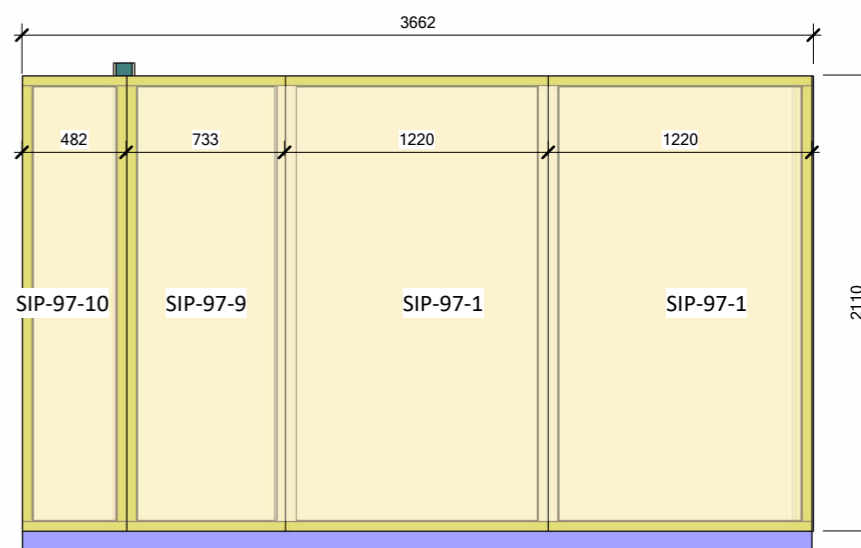

**2 Right Wall**  
1 : 35

**05. Wall Elevations**

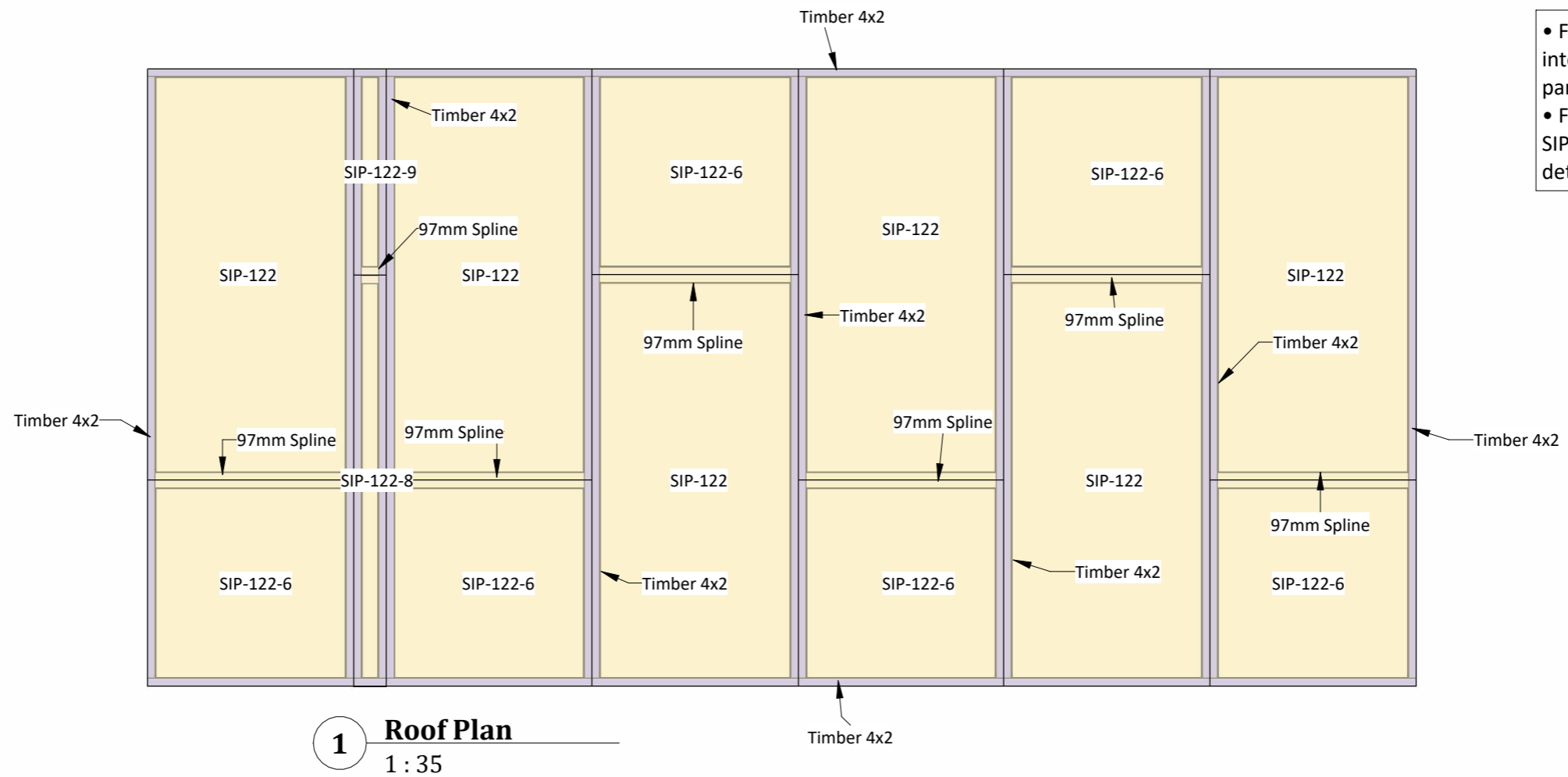

- Furring strips & door bars to be fitted into position as shown before roof panels
- Furring strips to line up with inside of SIP panel of side walls as shown in detail

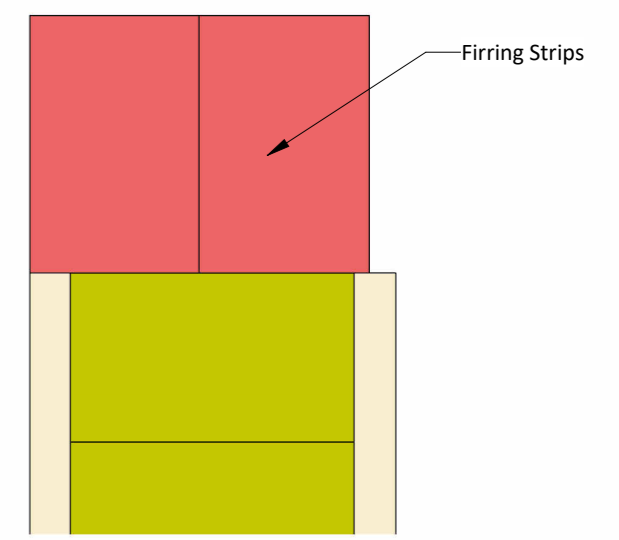
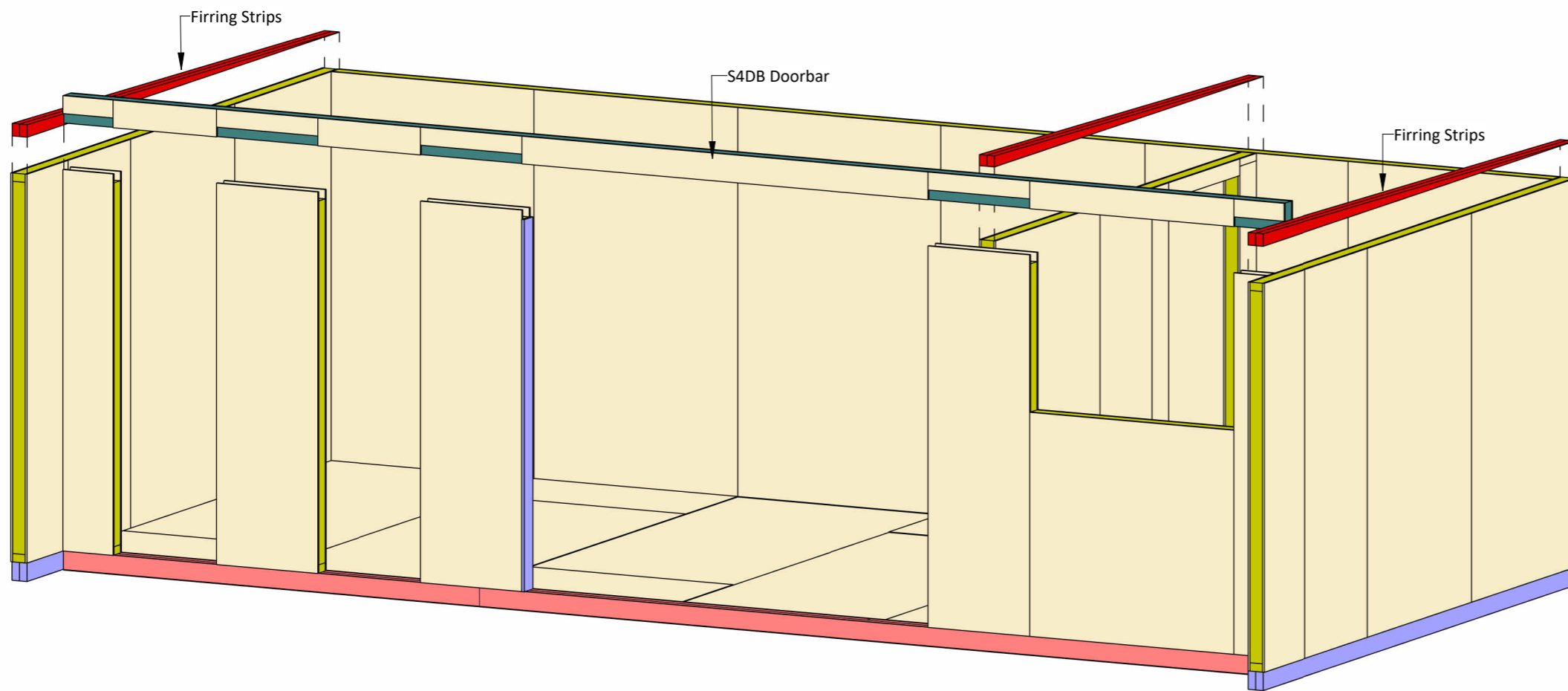

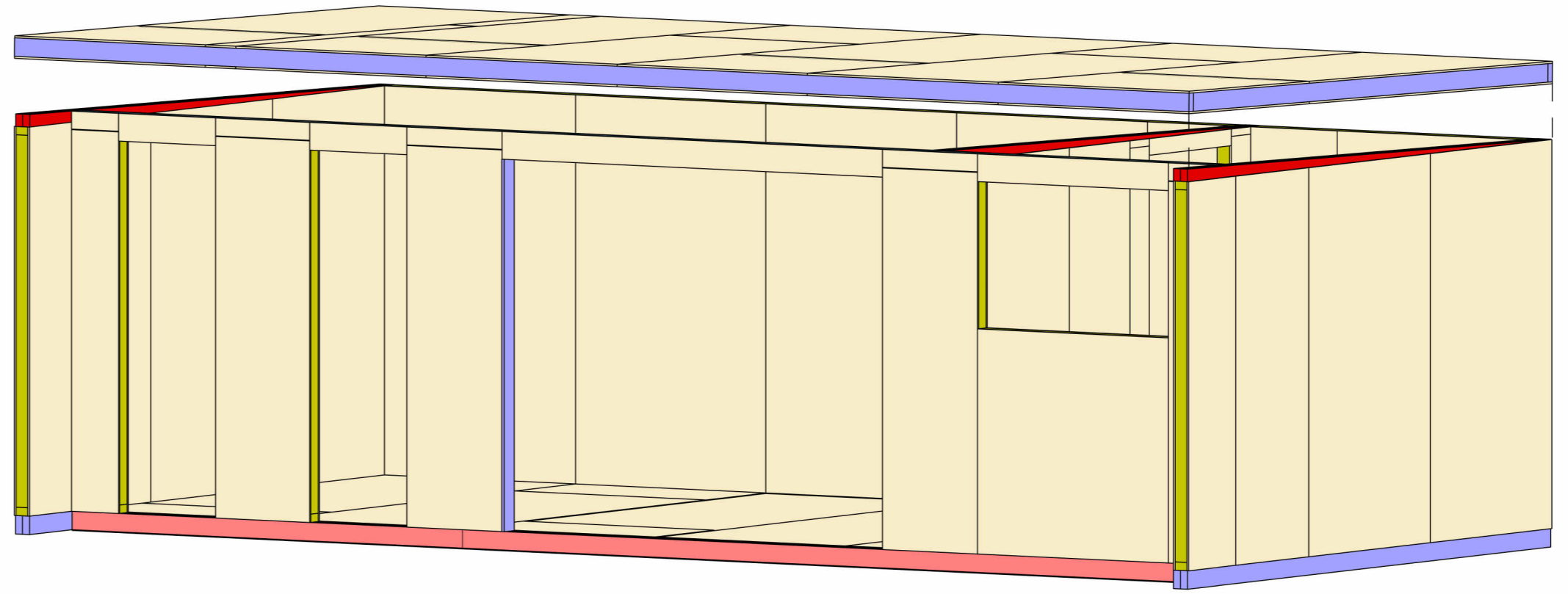

- Glue roof beam using PU Adhesive generously across the 100mm face of timber. Screw through both timbers using 5x80mm screws every 400mm.
- Timber fitted into 50mm rebate of panel using 5x50mm screws through face of OSB
- Roof beam & 4x2" joining splines to fit within 50mm rebate of SIP panels; glue & fix in place using 5x50mm screws
- completed roof assembly to be positioned on furring strips & fixed into position using correct length hex screws spaced @400mm centres as shown

\*breathable membrane to be installed once building has been assembled & before batten installation\*

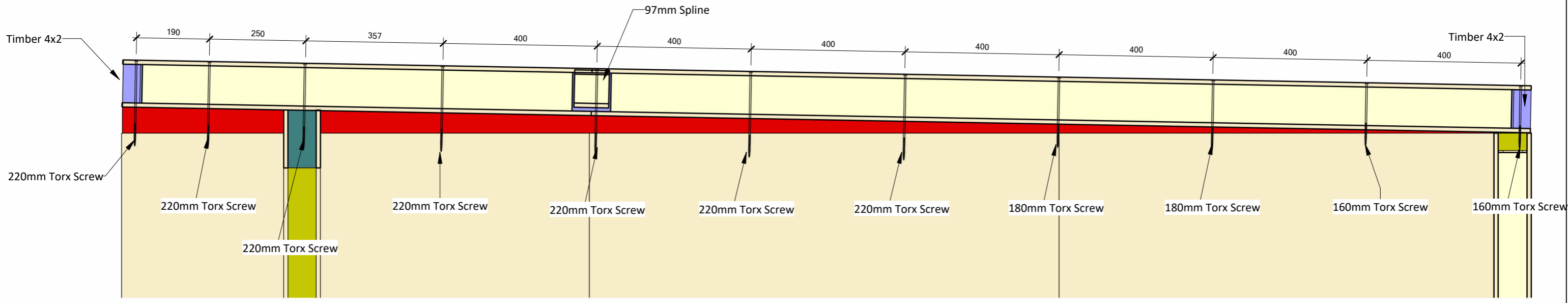

**2 Roof Section**  
1 : 10

**07. Roof Assembly**